

SPRINTER

FIFTH WHEELS • TRAVEL TRAILERS

2021
FALL
UPDATES



blade

HIGH-PERFORMANCE AIR FLOW SYSTEM



BLADE™ HIGH PERFORMANCE AIR HANDLING SYSTEMS

Engineered to maximize the output from today's high-performance RV air conditioners, Keystone's NEW patented air handling system delivers an average of 20% more cooling power and is built to withstand the rigors of the road. The Blade™ system is designed to accelerate air flow, eliminate leakage and failure points, deliver 360° circulation in the cabin, and withstand environmental and road stressors that lead to reduced performance.

COLEMAN MACH "THE QUIET SERIES" AIR CONDITIONER

Quietly turn hot days into chill ones with Sprinter's new RV A/C. Operating at 12-15 dB's lower than competitive models, this revolutionary technology cools you off without announcing itself.

Coleman-Mach
An AIRXCEL Brand



FAST-MOVING FLOORPLANS, CAMPER-FOCUSED DESIGN

Keystone Sprinter has geared up for 2021 with a single focus — to deliver the most livable, most comfortable fifth wheels and travel trailers at accessible price points. With their Camping Made Easy™ mantra in mind, Sprinter meticulously scrutinized campers' most-loved floorplans, making fine adjustments that prioritize function and comfort. Kitchens that work for week-long camping trips, top of the line furniture, and spaces that are perfectly laid out for optimal entertainment viewing.

New & Notable: Ultra-functional Kitchens

- Full kitchen island redesign w/ three drawers
- Residential stainless steel microwave
- 21" Stainless steel oven w/ storage drawers*
- Decorative pendant lighting over island*
- Wall-mounted, freestanding table w/ four chairs

New & Notable: Prioritizing Comfort

- Luxurious Thomas Payne theater seating w/ light, heat & massage
- Coleman-Mach® "The Quiet Series" A/C
- Comfort Package, now standard with two A/C's
- Blade™ high performance air handling system
- Upgraded interior LED lighting

New & Notable: Thoughtful Design Details

- Brilliant Silver Max sidewall & new exterior graphics package
- Two décor options, Urban (new) and Coastal Cottage
- Premium Astana Pine cabinetry
- Brushed nickel door and drawer hardware
- Marbled ivory kitchen backsplash
- Congoleum® resilient vinyl flooring
- Roller shades†
- Woven flooring in slide-outs
- Redesigned entertainment centers
- XL mirrored wardrobe doors*
- Panoramic bedroom window*
- Residential bedroom dresser*
- Redesigned bath vanity w/ two storage drawers
- Porcelain foot flush toilets

*Available in Sprinter Limited fifth wheel models only

†Available in Limited models only

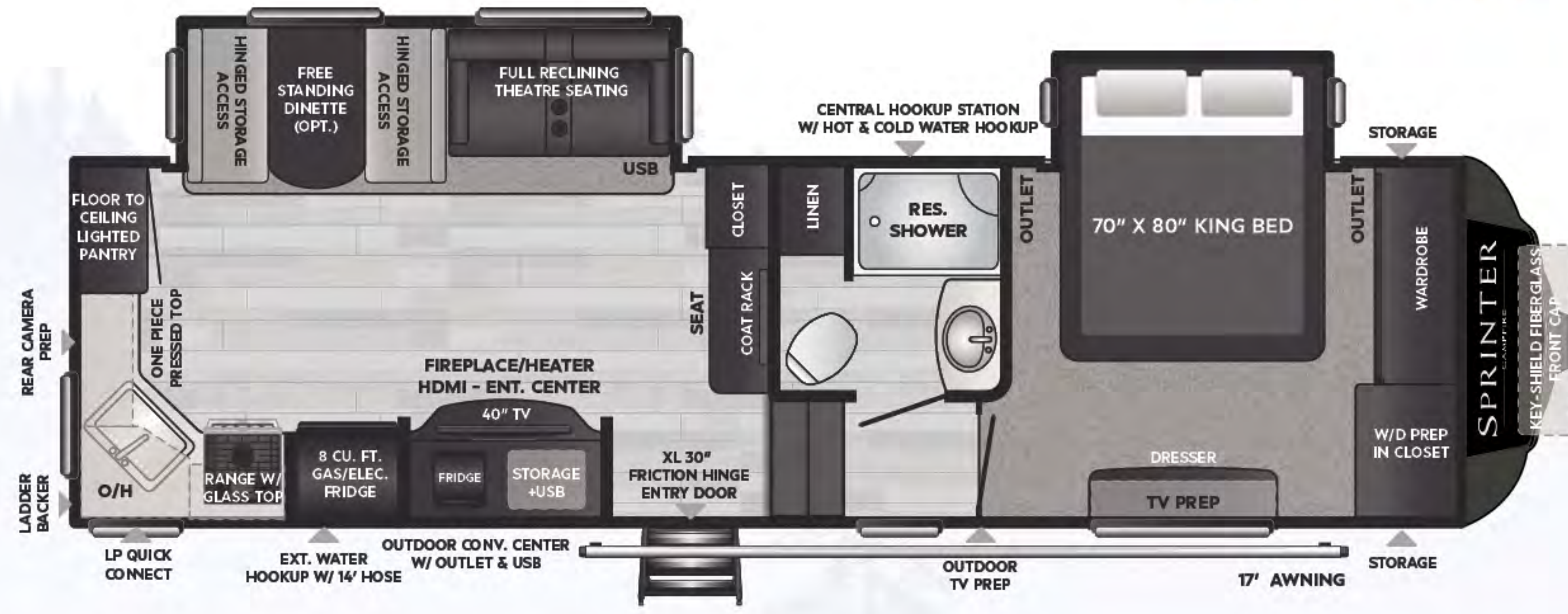

27ML | Mid-living w/ king bed slide, W/D prep, & floor-to-ceiling pantry

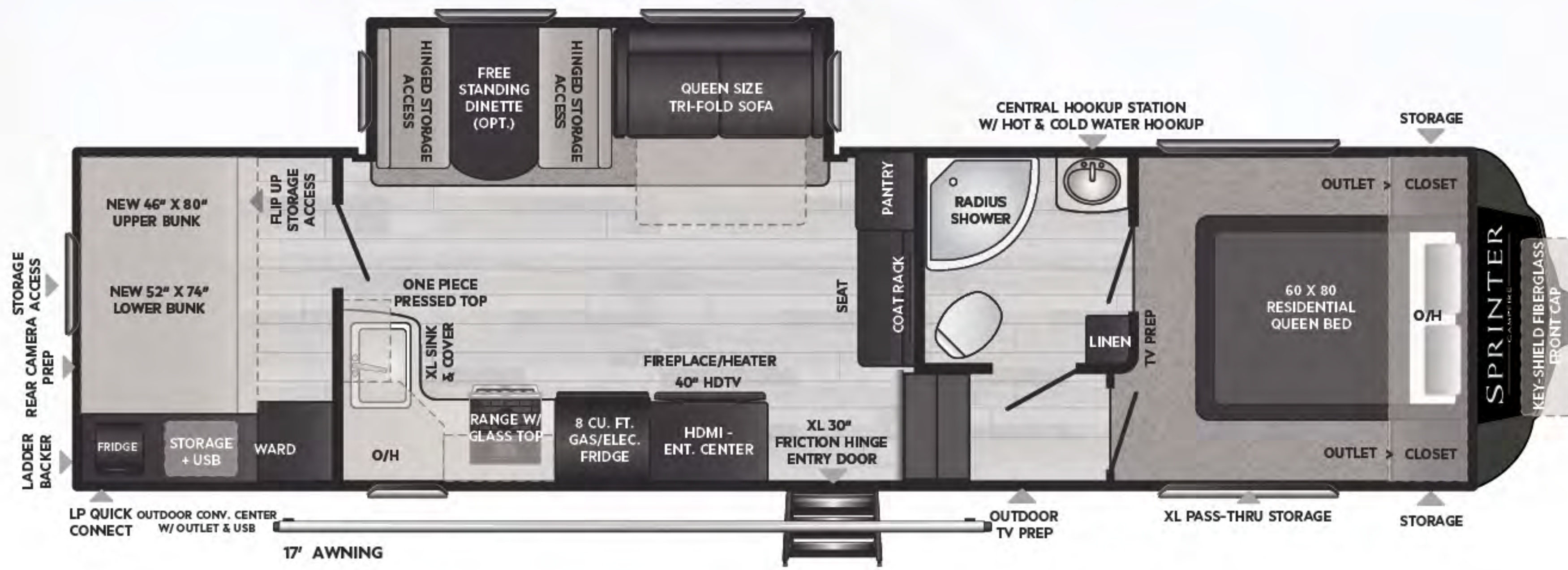

29BH | Private double over double bunkhouse w/ o/s convenience center

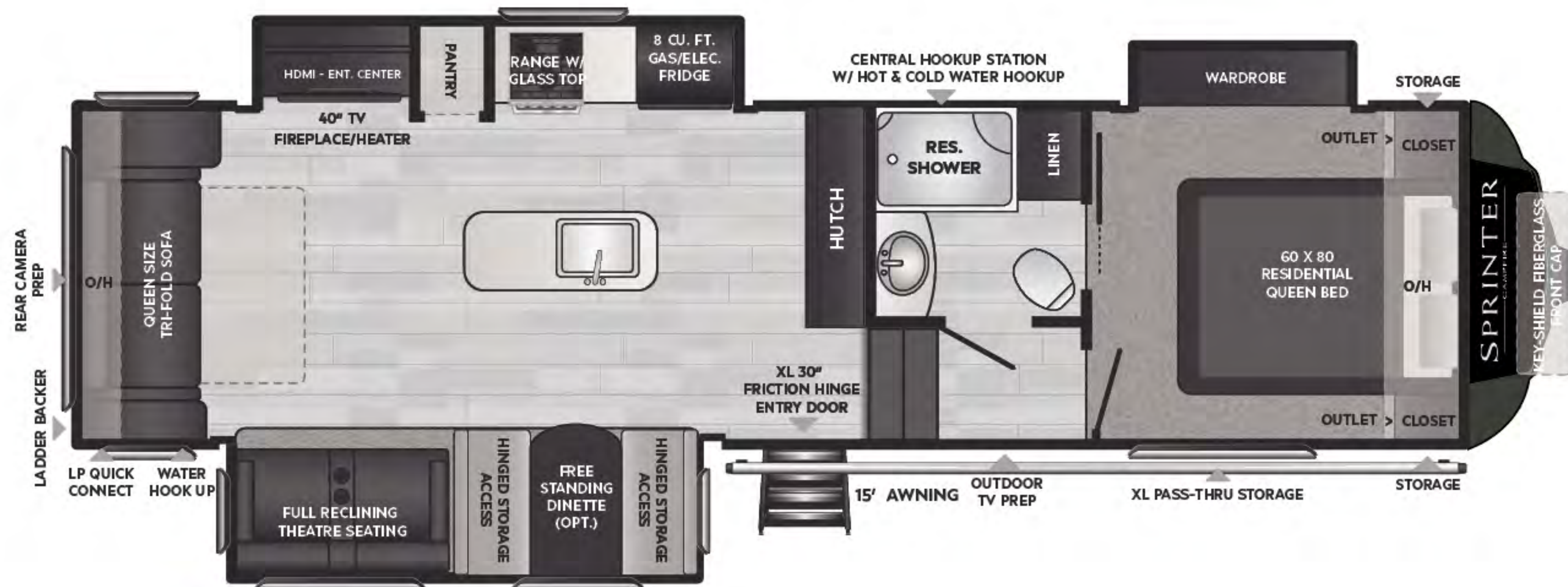

NEW! 30RLS | Rear living, ample storage, luxury bathroom

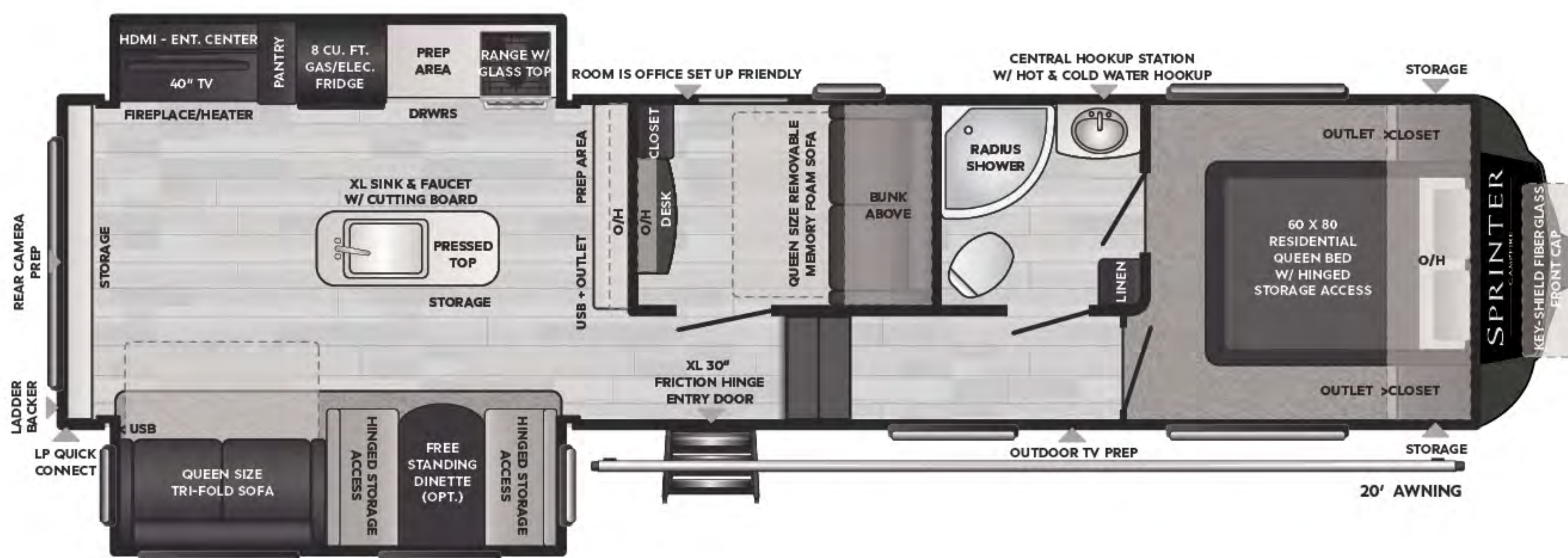

31MB | Hybrid mid-bunk w/ utility room and kitchen island

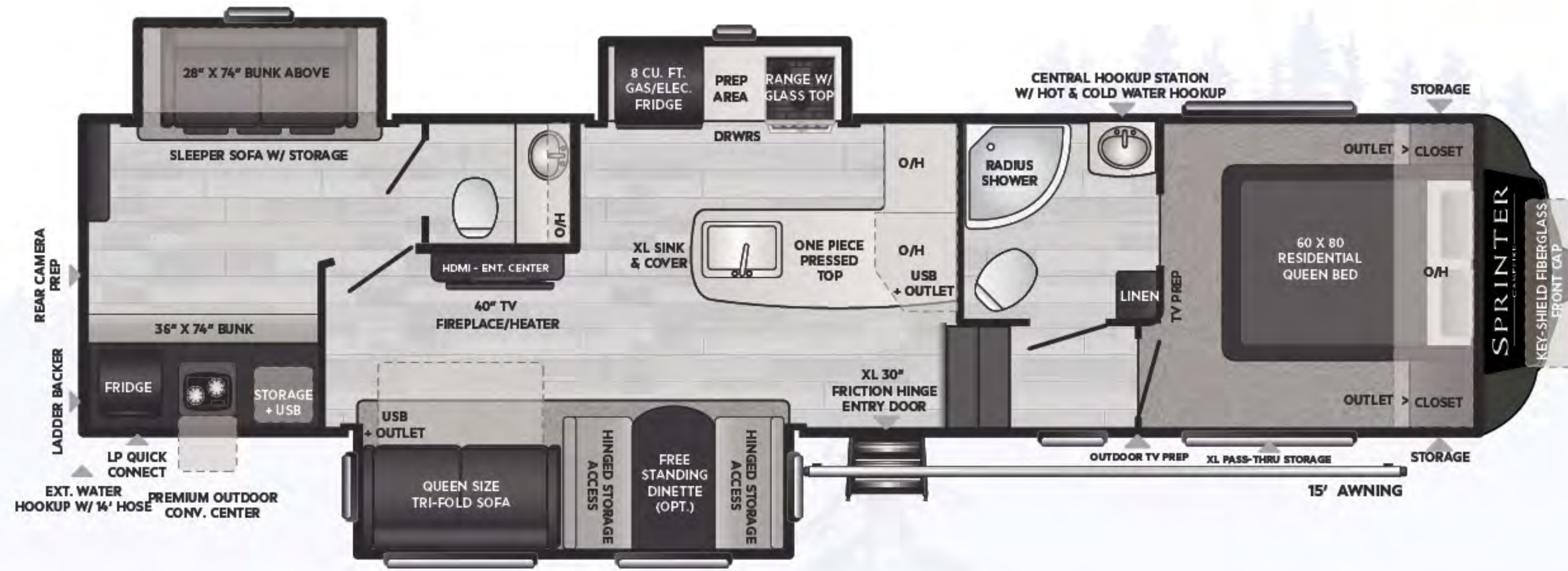

32BH | 1 1/2 baths w/ private bunkhouse

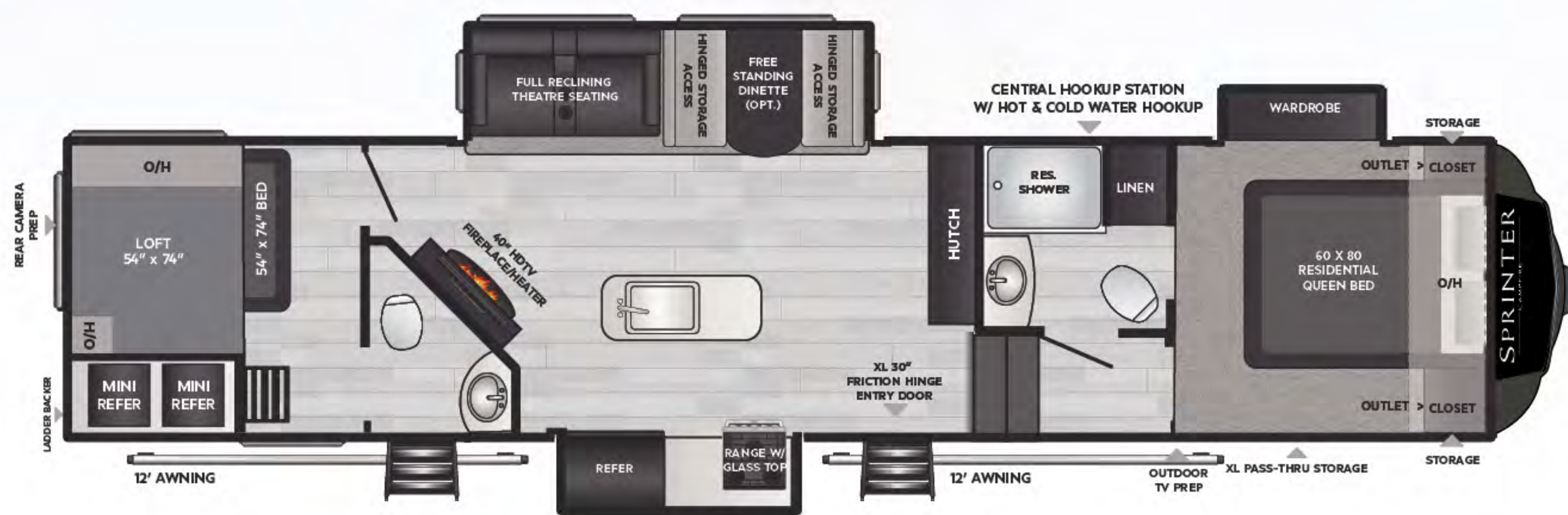

NEW! **35BH** | Rear bunk, 1 1/2 baths, outside kitchen

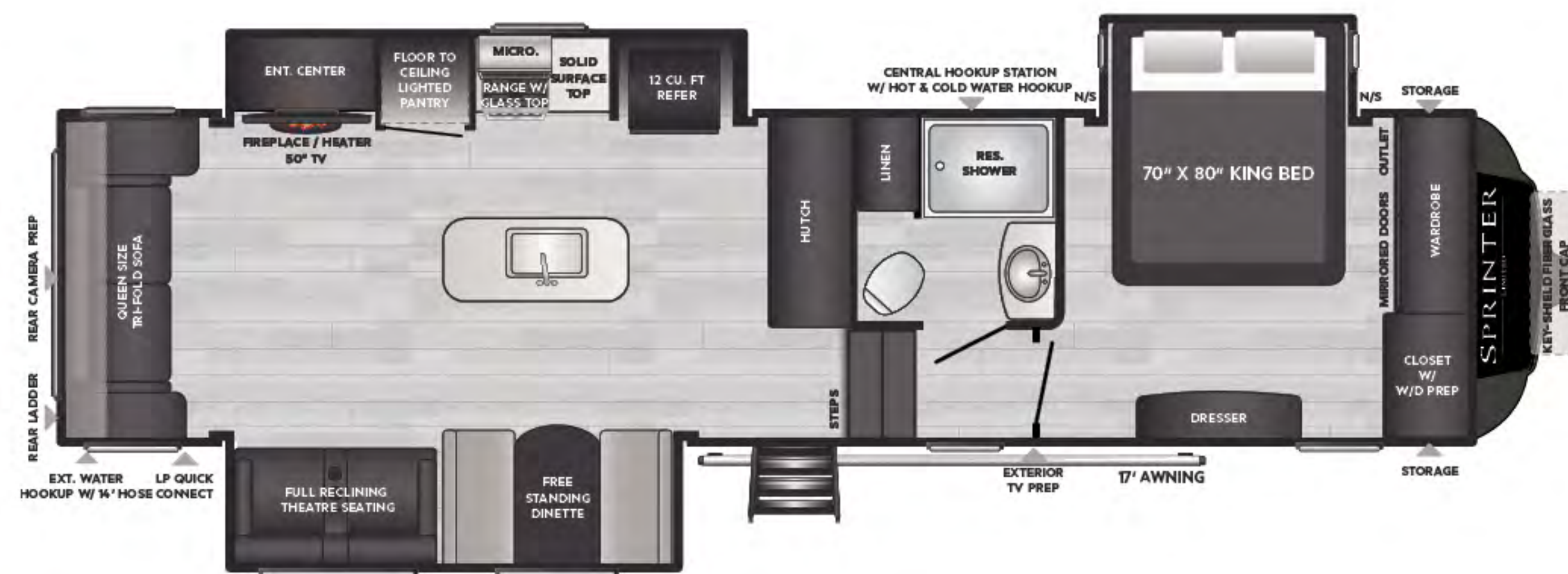

NEW! **3190RLS** | Rear living, full pantry, huge entertainment

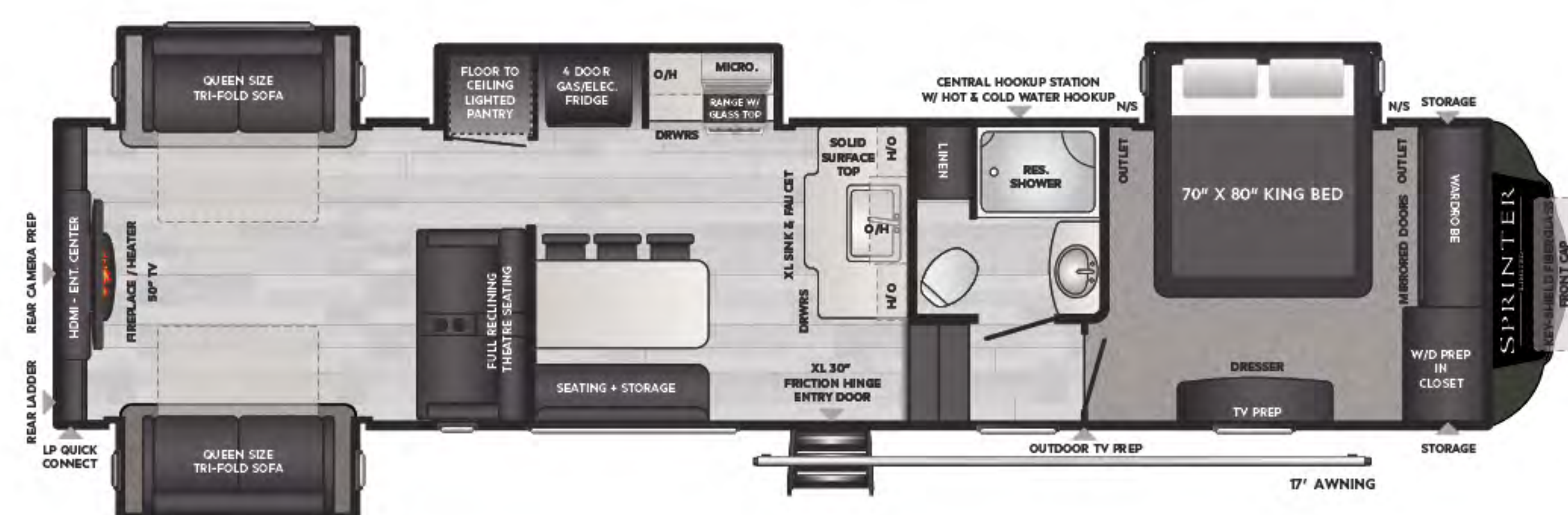

3530DEN | Rear den w/ bartop, tri-fold sleeper sofa, theater seating

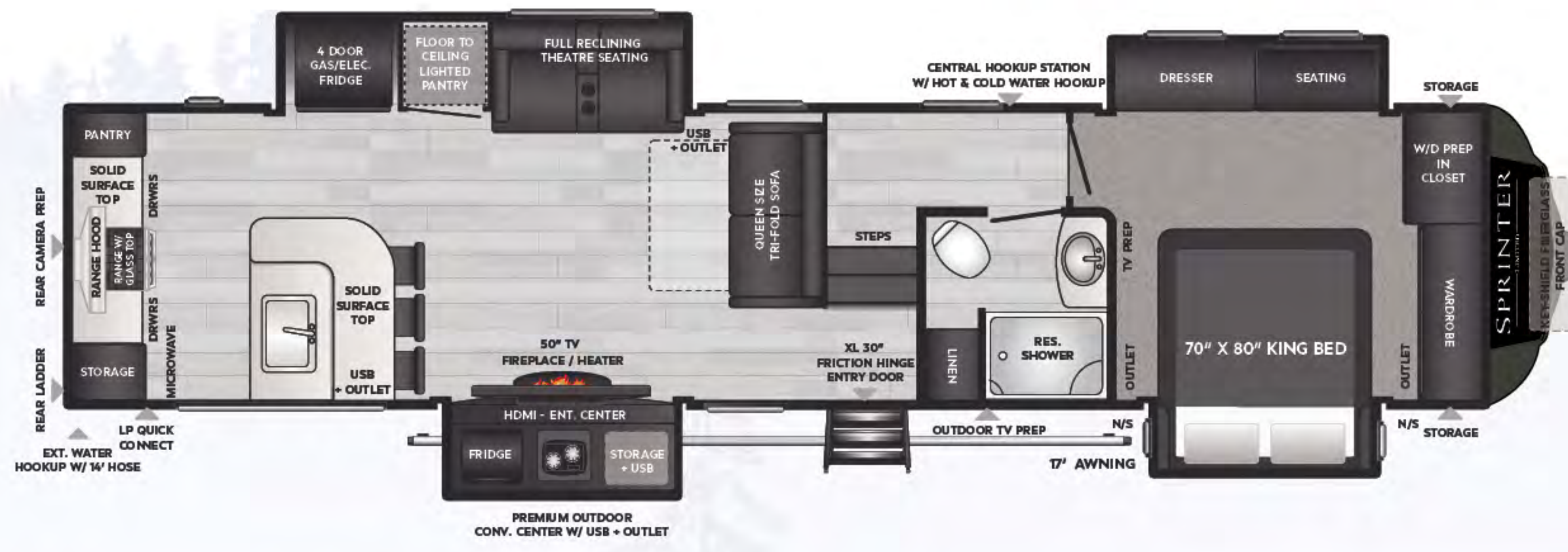

3550MLS | Mid living, entertaining kitchen area, master suite

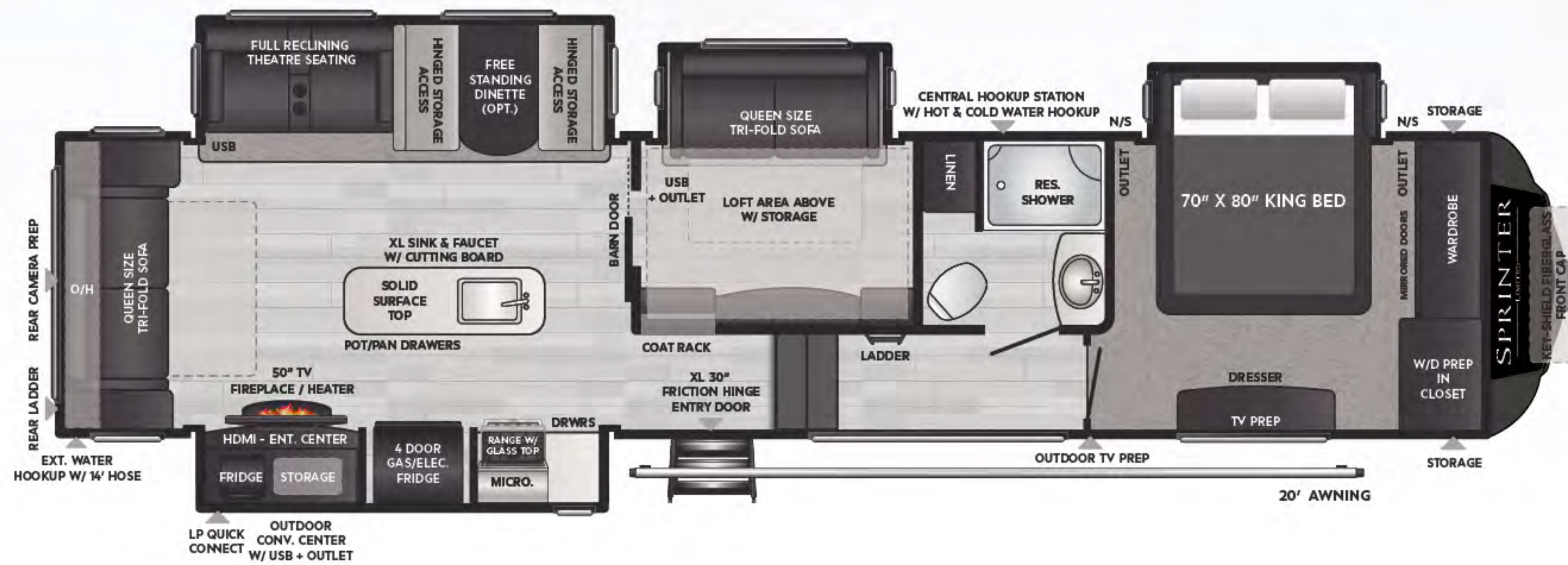

3570LFT | Mid bunkroom, overhead loft, king bed slide

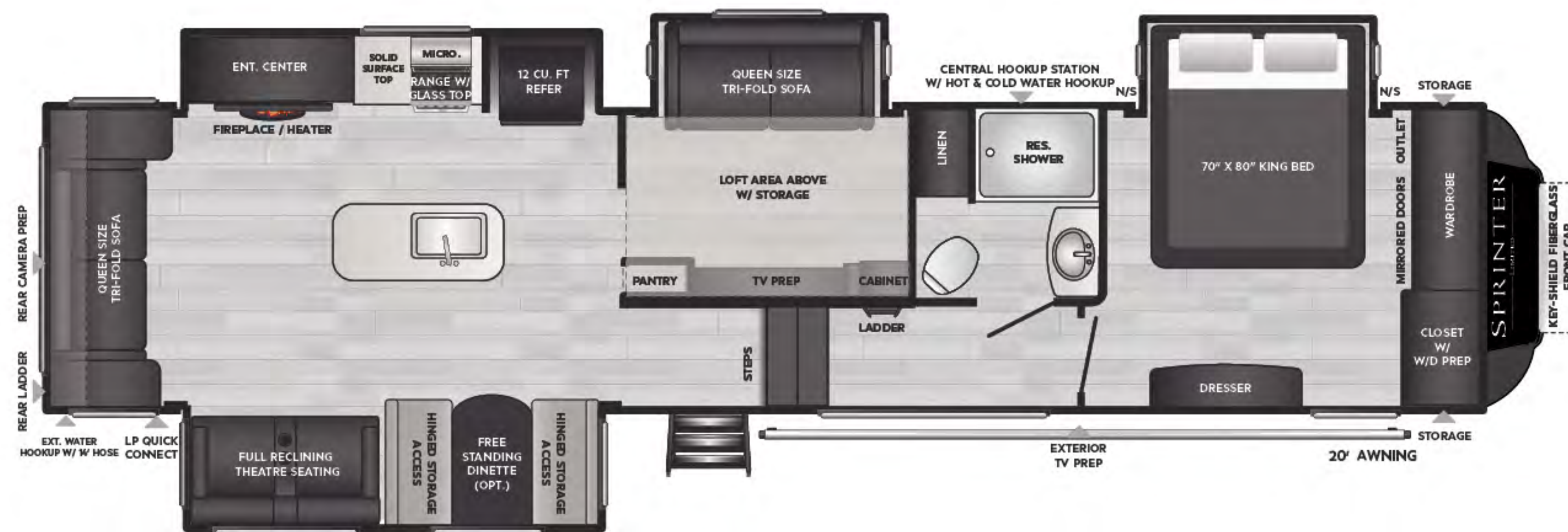

NEW! **3590LFT** | Rear living, bonus room, loft-style bunk

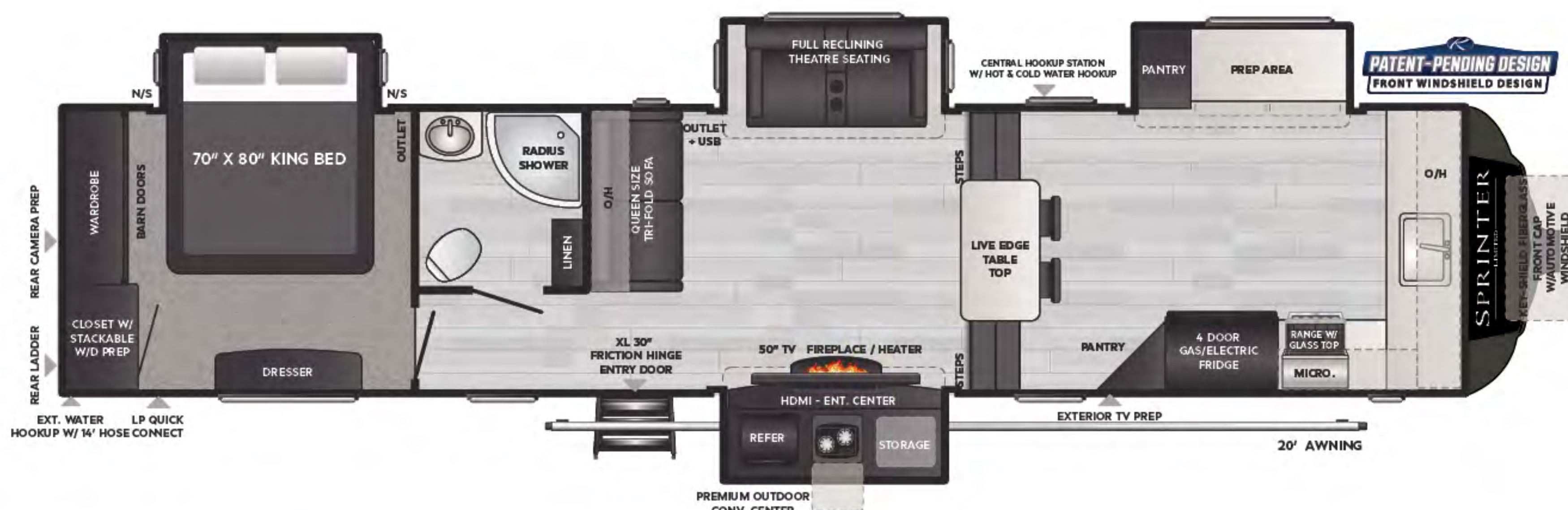

3610FKS | Executive kitchen w/ stackable W/D prep

SPRINTER | LIMITED FIFTH WHEELS

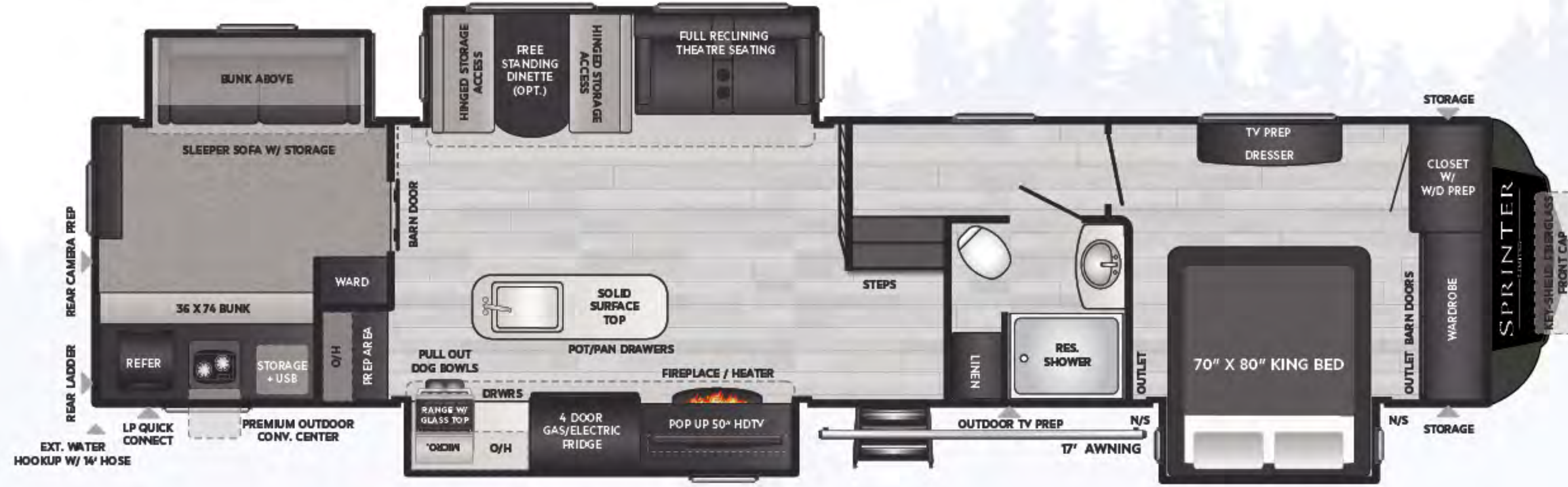

3620LBH | Unique open concept bunkhouse

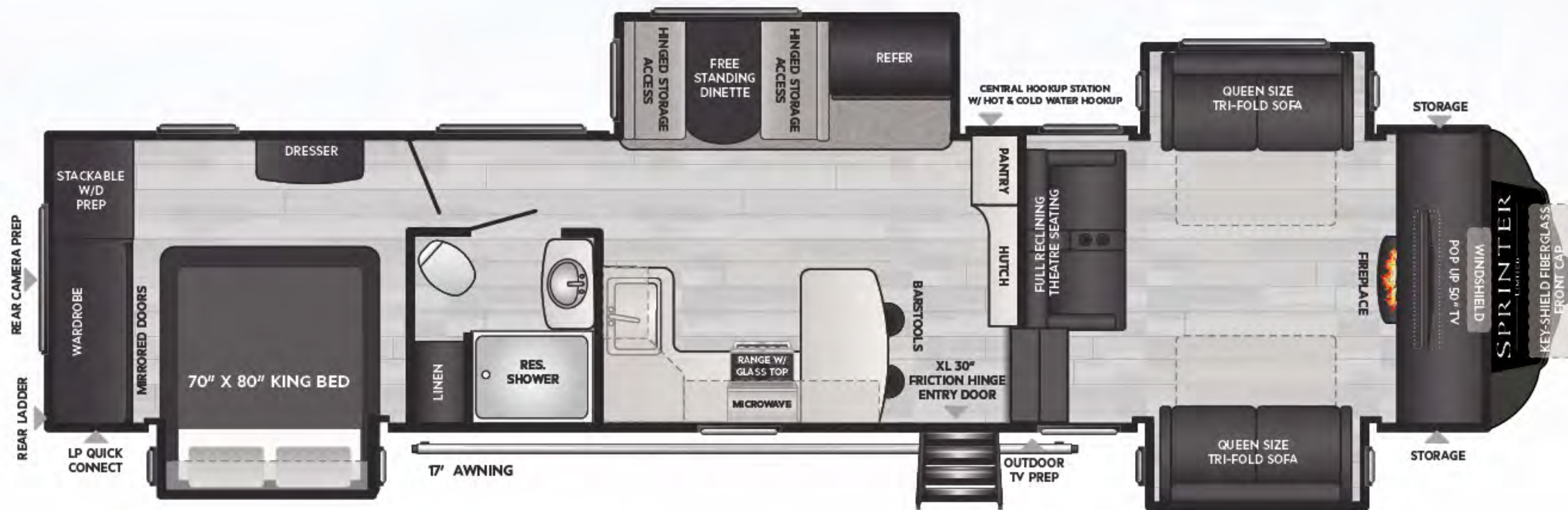

NEW! 3670FLS | Front living, full dinette, stackable W/D prep

SPRINTER | LIMITED TRAVEL TRAILERS

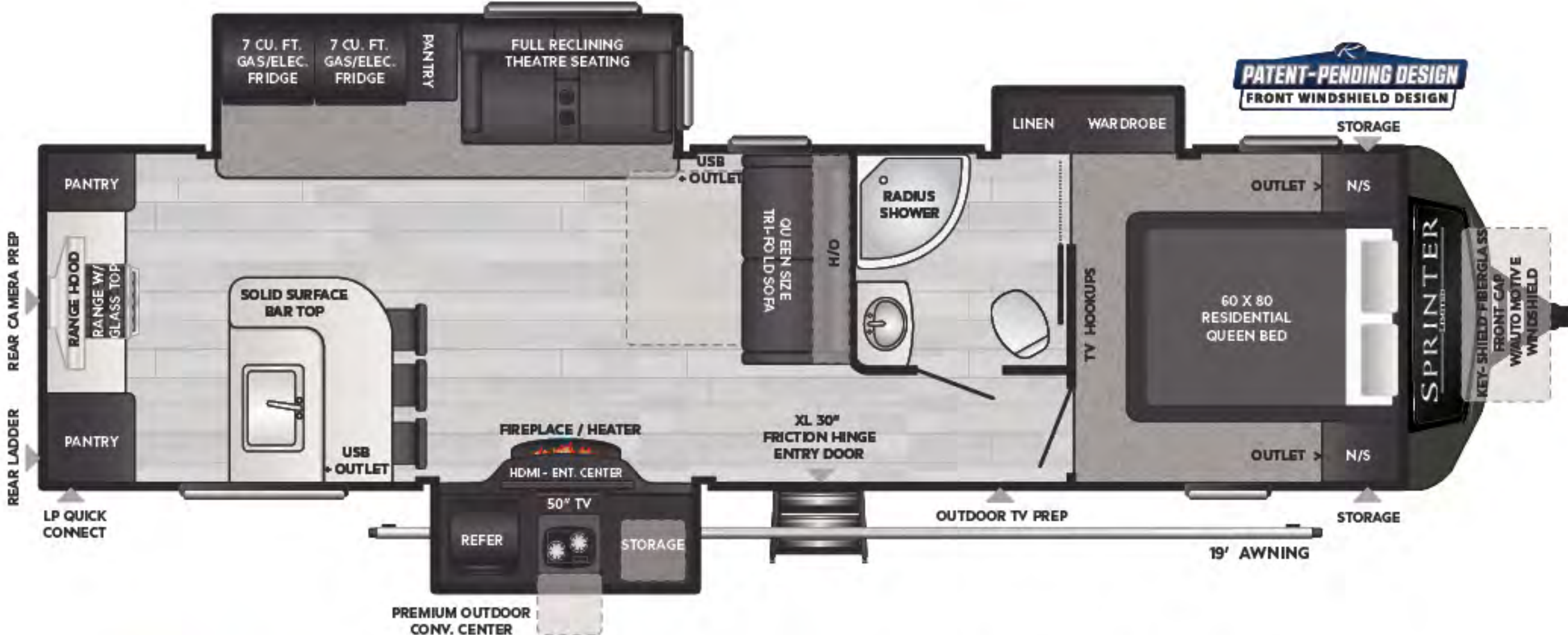

320MLS | Mid living, entertaining kitchen area, dual refrigerators

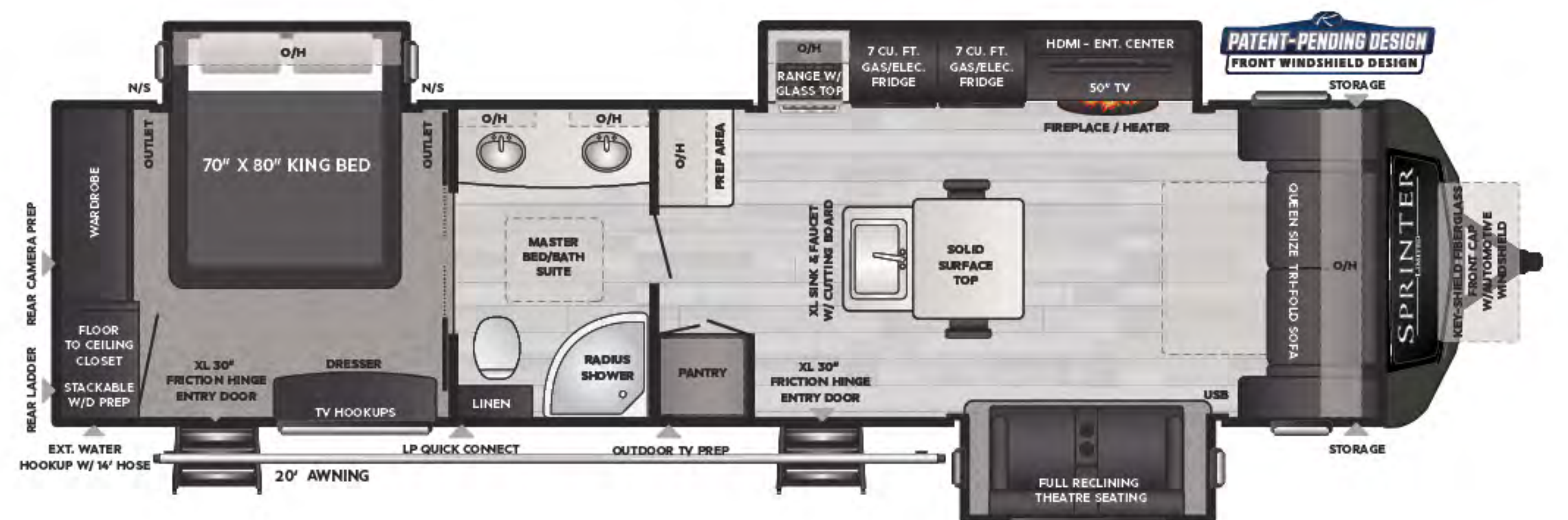

330KBS | Master suite, king bed, dual refrigerators, island

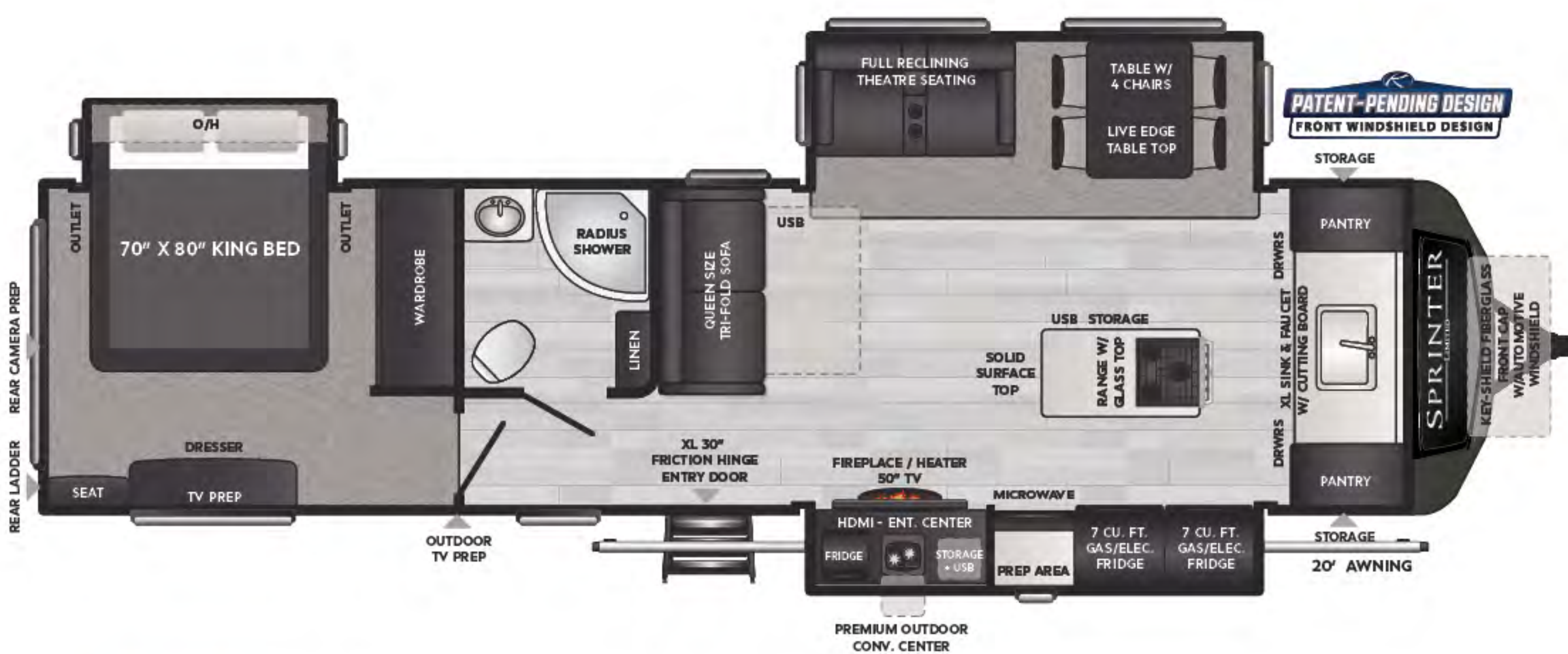

333FKS | Front kitchen, king bed slide, dual refrigerators

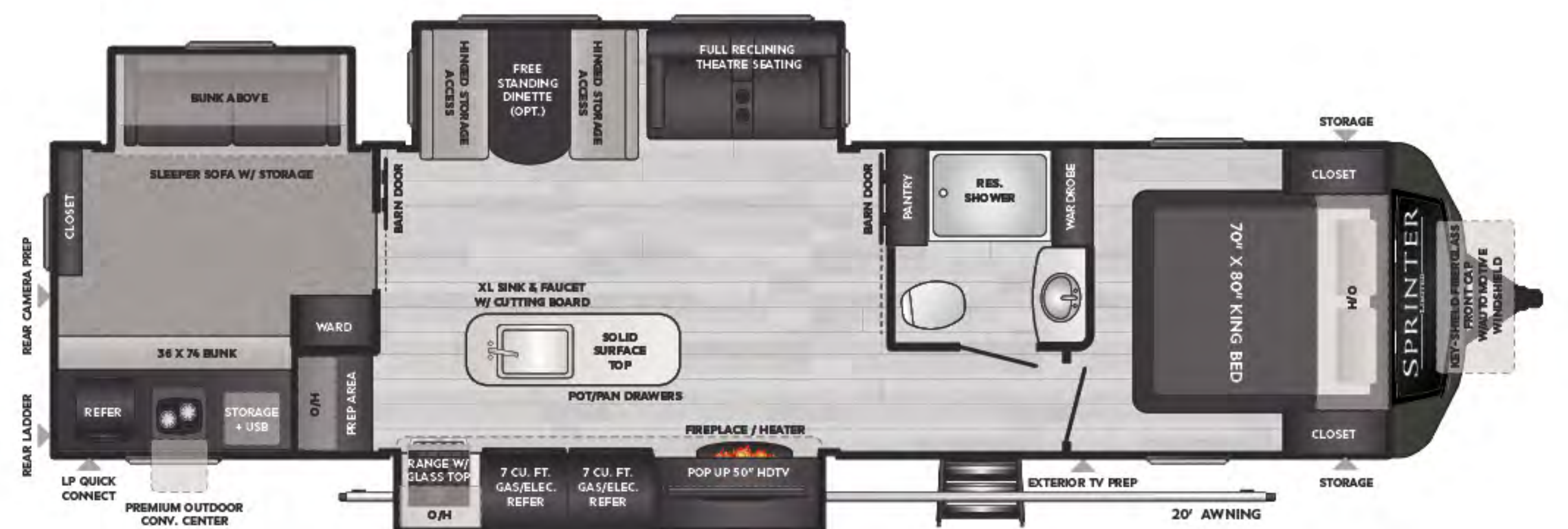

341BIK | Bunkhouse, dual refrigerators, king bed, theater seating

SPRINTER FIFTH WHEELS

MODEL	WEIGHT	CARRYING CAPACITY	HITCH WEIGHT	FRESH WATER	WASTE WATER	GRAY WATER	LPG	LENGTH*	WIDTH	HEIGHT	AWNING
27ML	9078	2922	1710	81	44	78	60	31, 10	8' 4"	13' 0"	17'
29BH	8824	3036	1570	81	44	88	60	34, 7	8' 4"	13' 0"	17'
30RLS	TBD	TBD	TBD	81	44	78	60	33' 8"	8' 4"	13' 0"	15'
31MB	9625	2475	1715	81	44	78	60	35, 11	8' 4"	13' 0"	20'
32BH	10160	1940	1735	81	78	44	60	36, 11	8' 4"	13' 0"	15'
35BH	TBD	TBD	TBD	TBD	TBD	TBD	TBD	TBD	TBD	TBD	TBD

SPRINTER LIMITED FIFTH WHEELS

MODEL	WEIGHT	CARRYING CAPACITY	HITCH WEIGHT	FRESH WATER	WASTE WATER	GRAY WATER	LPG	LENGTH*	WIDTH	HEIGHT	AWNING
3190RLS	10455	2445	2155	81	44	78	60	35' 3"	8' 4"	13' 2"	17'
3530DEN	11016	2984	2230	81	44	44	60	39, 0	8' 4"	13, 2	17'
3550MLS	11038	2962	2205	81	44	78	60	39, 0	8' 4"	13, 2	17'
3570LFT	11751	2249	2440	81	44	78	60	39, 6	8' 4"	13, 2	20'
3590LFT	TBD	TBD	TBD	81	44	78	60	39' 6"	8' 4"	13' 2"	20'
3610FKS	11315	2685	2395	81	34	102	60	40, 6	8' 4"	13, 4	20'
3620LBH	11780	2220	2185	81	44	102	60	40, 6	8' 4"	13, 4	17'
3670FLS	TBD	TBD	TBD	81	34	102	60	40' 6"	8' 4"	13' 4"	17'

SPRINTER LIMITED TRAVEL TRAILERS

MODEL	WEIGHT	CARRYING CAPACITY	HITCH WEIGHT	FRESH WATER	WASTE WATER	GRAY WATER	LPG	LENGTH*	WIDTH	HEIGHT	AWNING
320MLS	8815	2625	1040	81	34	68	60	36, 7	8' 4"	11, 3	19'
330KBS	8993	2507	1135	81	34	102	60	37, 9	8' 4"	11, 3	20'
333FKS	9144	2356	1210	81	34	68	60	37, 9	8' 4"	11, 3	20'
341BIK	9350	2150	1270	81	34	68	60	38, 10	8' 4"	11, 3	20'

DISCLAIMER: Product information is as accurate as possible as of the date of publication of this brochure. All features, floor plans, and specifications in this brochure are subject to change without notice. Please also consult Keystone's web site at www.keystonerv.com for more current product information and specifications. Tow Vehicle Disclaimer. CAUTION: Owners of Keystone recreational vehicles are solely responsible for the selection and proper use of tow vehicles. All customers should consult with a motor vehicle manufacturer or their dealer concerning the purchase and use of suitable tow vehicles for Keystone products. Keystone disclaims any liability or damages suffered as a result of the selection, operation, use or misuse of a tow vehicle. KEYSTONE'S LIMITED WARRANTY DOES NOT COVER DAMAGE TO THE RECREATIONAL VEHICLE OR THE TOW VEHICLE AS A RESULT OF THE SELECTION, OPERATION, USE OR MISUSE OF THE TOW VEHICLE. *Length is defined as the distance from the centerline of hitch pin/coupler to rear bumper of trailer. Please review owner's manual prior to purchase for more information on service warranties, extended use, towing and maintenance. Owner's manuals can be found at keystonerv.com.